



Report of: **Service Director, Public Protection**

Meeting of	Date	Agenda Item	Ward(s)
Licensing Sub-Committee	25 <sup>th</sup> August 2015		Highbury East

Delete as appropriate		Non-exempt
-----------------------	--	------------

**Subject: PREMISES LICENCE NEW APPLICATION**  
**RE: ZING ZING, 142 BLACKSTOCK ROAD, LONDON, N4 2DX**

## 1. Synopsis

- 1.1 This is an application for a new premises licence under the Licensing Act 2003.
- 1.2 The application is for a licence to allow:
  - The sale of alcohol for consumption off the premises: 12:00 to 23:00 on Mondays to Sundays.
  - The following opening hours: 10:00 to 23:00 on Mondays to Sundays.

## 2. Relevant Representations

Licensing Authority	Yes
Metropolitan Police	Yes
Noise	No
Health and Safety	No
Trading Standards	No

Public Health	No
Safeguarding Children	No
London Fire Brigade	No
Local residents	Yes: 4
Other bodies	No

### 3. Background

3.1 Papers are attached as follows:-

Appendix 1: application form; and copies of correspondence sent to representations.

Appendix 2: representations;

Appendix 3: suggested conditions and map of premises location.

3.2 Four local residents have submitted representations, in addition there are representations from the Police and the licensing authority.

### 4. Planning Implications

4.1 The Planning & Development section have not yet commented on the application.

### 5 Recommendations

5.1 To determine the application for a new premises licence under Section 17 of the Licensing Act 2003.

5.2 To consider that this address is in the Saturation or "Cumulative Impact Policy" of Islington. This special policy creates a rebuttable presumption that applications for new premises licences, club premises certificates, or variation applications that are likely to add to the existing cumulative impact will normally be refused, unless the applicant can demonstrate why the operation of the premises involved will not add to the cumulative impact or otherwise impact adversely on the promotion of the licensing objectives.

5.3 If the Committee grants the application it should be subject to:

- i. conditions prepared by the Licensing Officer which are consistent with the Operating Schedule (see appendix 3)
- ii. any conditions deemed appropriate by the Committee to promote the four licensing objectives.(see appendix 3)

**6 Conclusion and reasons for recommendations**

6.1 The Council is required to consider this application in the light of all relevant information, and if approval is given, it may attach such conditions as appropriate to promote the licensing objectives.

**Background papers:**

The Council's Statement of Licensing Policy  
Licensing Act 2003  
Secretary of States Guidance

**Final Report Clearance**

**Signed by**

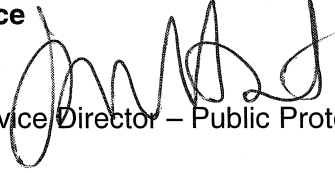
  
Service Director – Public Protection

Date

13.8.15

**Received by**

Head of Scrutiny and Democratic Services

Date

Report author: Licensing Service

Tel: 020 75027 3031

E-mail: [licensing@islington.gov.uk](mailto:licensing@islington.gov.uk)

WK/201588867

NF  
OK  
TL  
18/6/15

Application for a premises licence to be granted  
under the Licensing Act 2003

PLEASE READ THE FOLLOWING INSTRUCTIONS FIRST

Before completing this form please read the guidance notes at the end of the form. If you are completing this form by hand please write legibly in block capitals. In all cases ensure that your answers are inside the boxes and written in black ink. Use additional sheets if necessary.

You may wish to keep a copy of the completed form for your records.

I/We ZING ZING EXPRESS LIMITED

(Insert name(s) of applicant)

apply for a premises licence under section 17 of the Licensing Act 2003 for the premises described in Part 1 below (the premises) and I/we are making this application to you as the relevant licensing authority in accordance with section 12 of the Licensing Act 2003

Part 1 - Premises Details

Postal address of premises or, if none, ordnance survey map reference or description Zing Zing 142 Blackstock Road			
Post town	London	Postcode	N4 2DX

Telephone number at premises (if any)	0207 226 6664
Non-domestic rateable value of premises	£14,500

Part 2 - Applicant Details

Please state whether you are applying for a premises licence as

Please tick as appropriate

- a) an individual or individuals \*  please complete section (A)
- b) a person other than an individual \*
  - i. as a limited company  please complete section (B)
  - ii. as a partnership  please complete section (B)
  - iii. as an unincorporated association or  please complete section (B)
  - iv. other (for example a statutory corporation)  please complete section (B)
- c) a recognised club  please complete section (B)
- d) a charity  please complete section (B)

Application #1

IP2/455999  
£190.00/ELMS  
18/06/15

- e) the proprietor of an educational establishment  please complete section (B)
- f) a health service body  please complete section (B)
- g) a person who is registered under Part 2 of the Care Standards Act 2000 (c14) in respect of an independent hospital in Wales  please complete section (B)
- ga) a person who is registered under Chapter 2 of Part 1 of the Health and Social Care Act 2008 (within the meaning of that Part) in an independent hospital in England  please complete section (B)
- h) the chief officer of police of a police force in England and Wales  please complete section (B)

\* If you are applying as a person described in (a) or (b) please confirm:

Please tick yes

I am carrying on or proposing to carry on a business which involves the use of the premises for licensable activities; or

I am making the application pursuant to a  
 statutory function or   
 a function discharged by virtue of Her Majesty's prerogative

**(A) INDIVIDUAL APPLICANTS** (fill in as applicable)

Mr <input type="checkbox"/>	Mrs <input type="checkbox"/>	Miss <input type="checkbox"/>	Ms <input type="checkbox"/>	Other Title (for example, Rev)	
<b>Surname</b>			<b>First names</b>		
I am 18 years old or over				<input type="checkbox"/>	Please tick yes
Current postal address if different from premises address					
Post town				Postcode	
<b>Daytime contact telephone number</b>					
<b>E-mail address (optional)</b>					

**SECOND INDIVIDUAL APPLICANT (if applicable)**

Mr <input type="checkbox"/>	Mrs <input type="checkbox"/>	Miss <input type="checkbox"/>	Ms <input type="checkbox"/>	Other Title (for example, Rev)	
Surname			First names		
I am 18 years old or over					<input type="checkbox"/> Please tick yes
Current postal address if different from premises address					
Post town				Postcode	
Daytime contact telephone number					
E-mail address (optional)					

**(B) OTHER APPLICANTS**

Please provide name and registered address of applicant in full. Where appropriate please give any registered number. In the case of a partnership or other joint venture (other than a body corporate), please give the name and address of each party concerned.

Name ZING ZING EXPRESS LIMITED
Address 142 BLACKSTOCK ROAD FINSBURY PARK LONDON N4 2DX
Registered number (where applicable) 08198973
Description of applicant (for example, partnership, company, unincorporated association etc.) Private Limited Company
Telephone number (if any)
E-mail address (optional)

### Part 3 Operating Schedule

When do you want the premises licence to start?

DD	MM	YYYY					
[?]	[?]	[?]	[?]	[?]	[?]	[?]	[?]

If you wish the licence to be valid only for a limited period, when do you want it to end?

DD	MM	YYYY					
[?]	[?]	[?]	[?]	[?]	[?]	[?]	[?]

Please give a general description of the premises (please read guidance note 1)  
Take away premises for consumption off the premises only.

If 5,000 or more people are expected to attend the premises at any one time, please state the number expected to attend.

#### What licensable activities do you intend to carry on from the premises?

(Please see sections 1 and 14 of the Licensing Act 2003 and Schedules 1 and 2 to the Licensing Act 2003)

Provision of regulated entertainment

Please tick any that apply

- a) plays (if ticking yes, fill in box A)
- b) films (if ticking yes, fill in box B)
- c) indoor sporting events (if ticking yes, fill in box C)
- d) boxing or wrestling entertainment (if ticking yes, fill in box D)
- e) live music (if ticking yes, fill in box E)
- f) recorded music (if ticking yes, fill in box F)
- g) performances of dance (if ticking yes, fill in box G)
- h) anything of a similar description to that falling within (e), (f) or (g) (if ticking yes, fill in box H)

Provision of late night refreshment (if ticking yes, fill in box I)

Supply of alcohol (if ticking yes, fill in box J)

In all cases complete boxes K, L and M

**A**

<b>Plays</b> Standard days and timings (please read guidance note 6)			<b><u>Will the performance of a play take place indoors or outdoors or both – please tick</u></b> (please read guidance note 2)	Indoors	<input type="checkbox"/>
				Outdoors	<input type="checkbox"/>
				Both	<input type="checkbox"/>
Day	Start	Finish	<b><u>Please give further details here</u></b> (please read guidance note 3)		
Mon					
Tue			<b><u>State any seasonal variations for performing plays</u></b> (please read guidance note 4)		
Wed					
Thur			<b><u>Non standard timings. Where you intend to use the premises for the performance of plays at different times to those listed in the column on the left, please list</u></b> (please read guidance note 5)		
Fri					
Sat					
Sun					



**B**

<b>Films</b> Standard days and timings (please read guidance note 6)			<b>Will the exhibition of films take place indoors or outdoors or both – please tick</b> (please read guidance note 2)	Indoors	<input type="checkbox"/>			
				Outdoors	<input type="checkbox"/>			
				Both	<input type="checkbox"/>			
Day	Start	Finish	<b>Please give further details here</b> (please read guidance note 3)					
Mon								
Tue								
Wed						<b>State any seasonal variations for the exhibition of films</b> (please read guidance note 4)		
Thur								
Fri						<b>Non standard timings. Where you intend to use the premises for the exhibition of films at different times to those listed in the column on the left, please list</b> (please read guidance note 5)		
Sat								
Sun								

C

Indoor sporting events Standard days and timings (please read guidance note 6)			<u>Please give further details</u> (please read guidance note 3)
Day	Start	Finish	
Mon			
Tue			<u>State any seasonal variations for indoor sporting events</u> (please read guidance note 4)
Wed			
Thur			<u>Non standard timings. Where you intend to use the premises for indoor sporting events at different times to those listed in the column on the left, please list</u> (please read guidance note 5)
Fri			
Sat			
Sun			

**D**

<b>Boxing or wrestling entertainments</b> Standard days and timings (please read guidance note 6)			<b><u>Will the boxing or wrestling entertainment take place indoors or outdoors or both – please tick</u></b> (please read guidance note 2)	Indoors	<input type="checkbox"/>
				Outdoors	<input type="checkbox"/>
Both	<input type="checkbox"/>				
Day	Start	Finish	<b><u>Please give further details here</u></b> (please read guidance note 3)		
Mon					
Tue					
Wed			<b><u>State any seasonal variations for boxing or wrestling entertainment</u></b> (please read guidance note 4)		
Thur					
Fri			<b><u>Non standard timings. Where you intend to use the premises for boxing or wrestling entertainment at different times to those listed in the column on the left, please list</u></b> (please read guidance note 5)		
Sat					
Sun					

**E**

<b>Live music</b> Standard days and timings (please read guidance note 6)			<b><u>Will the performance of live music take place indoors or outdoors or both – please tick</u></b> (please read guidance note 2)	Indoors	<input type="checkbox"/>
				Outdoors	<input type="checkbox"/>
				Both	<input type="checkbox"/>
<b>Day</b>	<b>Start</b>	<b>Finish</b>	<b><u>Please give further details here</u></b> (please read guidance note 3)		
Mon					
Tue			<b><u>State any seasonal variations for the performance of live music</u></b> (please read guidance note 4)		
Wed					
Thur			<b><u>Non standard timings. Where you intend to use the premises for the performance of live music at different times to those listed in the column on the left, please list</u></b> (please read guidance note 5)		
Fri					
Sat					
Sun					

**F**

<b>Recorded music</b> Standard days and timings (please read guidance note 6)			<b>Will the playing of recorded music take place indoors or outdoors or both – please tick</b> (please read guidance note 2)	Indoors	<input type="checkbox"/>			
				Outdoors	<input type="checkbox"/>			
				Both	<input type="checkbox"/>			
Day	Start	Finish	<b>Please give further details here</b> (please read guidance note 3)					
Mon								
Tue								
Wed						<b>State any seasonal variations for the playing of recorded music</b> (please read guidance note 4)		
Thur								
Fri						<b>Non standard timings. Where you intend to use the premises for the playing of recorded music at different times to those listed in the column on the left, please list</b> (please read guidance note 5)		
Sat								
Sun								

**G**

<b>Performances of dance</b> Standard days and timings (please read guidance note 6)			<b><u>Will the performance of dance take place indoors or outdoors or both – please tick</u></b> (please read guidance note 2)	Indoors	<input type="checkbox"/>
				Outdoors	<input type="checkbox"/>
				Both	<input type="checkbox"/>
<b>Day</b>	<b>Start</b>	<b>Finish</b>	<b><u>Please give further details here</u></b> (please read guidance note 3)		
Mon					
Tue					
Wed					
Thur					
			<b><u>State any seasonal variations for the performance of dance</u></b> (please read guidance note 4)		
Fri					
Sat					
Sun					
			<b><u>Non standard timings. Where you intend to use the premises for the performance of dance at different times to those listed in the column on the left, please list</u></b> (please read guidance note 5)		
Fri					
Sat					
Sun					

H

<b>Anything of a similar description to that falling within (e), (f) or (g)</b> Standard days and timings (please read guidance note 6)			Please give a description of the type of entertainment you will be providing		
Day	Start	Finish	<b>Will this entertainment take place indoors or outdoors or both – please tick</b> (please read guidance note 2)	Indoors	<input type="checkbox"/>
Mon				Outdoors	<input type="checkbox"/>
				Both	<input type="checkbox"/>
Tue			<b>Please give further details here</b> (please read guidance note 3)		
Wed					
Thur			<b>State any seasonal variations for entertainment of a similar description to that falling within (e), (f) or (g)</b> (please read guidance note 4)		
Fri					
Sat			<b>Non standard timings. Where you intend to use the premises for the entertainment of a similar description to that falling within (e), (f) or (g) at different times to those listed in the column on the left, please list</b> (please read guidance note 5)		
Sun					



<b>Late night refreshment</b> Standard days and timings (please read guidance note 6)			<b>Will the provision of late night refreshment take place indoors or outdoors or both – please tick</b> (please read guidance note 2)	Indoors	<input type="checkbox"/>
				Outdoors	<input type="checkbox"/>
				Both	<input type="checkbox"/>
Day	Start	Finish			
Mon			<b><u>Please give further details here</u></b> (please read guidance note 3)		
Tue					
Wed			<b><u>State any seasonal variations for the provision of late night refreshment</u></b> (please read guidance note 4)		
Thur					
Fri			<b><u>Non standard timings. Where you intend to use the premises for the provision of late night refreshment at different times, to those listed in the column on the left, please list</u></b> (please read guidance note 5)		
Sat					
Sun					



J

<b>Supply of alcohol</b> Standard days and timings (please read guidance note 6)			<b>Will the supply of alcohol be for consumption – please tick</b> (please read guidance note 7)	On the premises	<input type="checkbox"/>
				Off the premises	<input checked="" type="checkbox"/>
				Both	<input type="checkbox"/>
Day	Start	Finish	<b>State any seasonal variations for the supply of alcohol!</b> (please read guidance note 4)		
Mon	12:00	23:00			
Tue	12:00	23:00			
Wed	12:00	23:00			
Thur	12:00	23:00			
Fri	12:00	23:00			
Sat	12:00	23:00			
Sun	12:00	23:00			
			<b>Non standard timings. Where you intend to use the premises for the supply of alcohol at different times to those listed in the column on the left, please list</b> (please read guidance note 5)		

State the name and details of the individual whom you wish to specify on the licence as designated premises supervisor:

Name Joshua James Magidson

Postcode 
Personal licence number (if known) TBC
Issuing licensing authority (if known) TBC

K

Please highlight any adult entertainment or services, activities, other entertainment or matters ancillary to the use of the premises that may give rise to concern in respect of children (please read guidance note 8).

L

Hours premises are open to the public Standard days and timings (please read guidance note 6)			State any seasonal variations (please read guidance note 4)
Day	Start	Finish	
Mon	12:00	23:00	<p><b>Non standard timings. Where you intend the premises to be open to the public at different times from those listed in the column on the left, please list</b> (please read guidance note 5)</p>
Tue	12:00	23:00	
Wed	12:00	23:00	
Thur	12:00	23:00	
Fri	12:00	23:00	
Sat	12:00	23:00	
Sun	12:00	23:00	

**M Describe the steps you intend to take to promote the four licensing objectives:**

**a) General – all four licensing objectives (b, c, d and e) (please read guidance note 9)**

Take away premises for consumption off the premises only.

The following conditions are proposed:

1. The Sale of alcohol shall be ancillary to the purchase of food.
2. Alcohol shall not be sold in an open container or be consumed in the licensed premises.
3. CCTV shall be installed, operated and maintained in agreement with the Police. The system will enable frontal identification of every person entering the premises. The system shall record in real time and operate whilst the premises are open for licensable activities. The recordings shall be kept available for a minimum of 31 days. Recordings shall be made available to an Authorised Officer or a Police Officer (subject to the Data Protection Act 1998) within 24 hours of any request.
4. The licensee shall put arrangements in place to ensure that before serving alcohol to young persons, staff ask to see accredited proof of age cards e.g. Citizencard, a Passport, or UK Driving Licence bearing the photograph and date of birth of the bearer.
5. The licensee and staff should note any refusals to sell to young people in a refusals log. The refusals log shall be checked and signed monthly by the designated premises supervisor. The refusals log shall be made available for inspection by the licensing team, police or trading standards.

**b) The prevention of crime and disorder**

see a) above

**c) Public safety**

see a) above

**d) The prevention of public nuisance**

see a) above

**e) The protection of children from harm**

see a) above

**Checklist:**

**Please tick to indicate agreement**

- I have made or enclosed payment of the fee.
- I have enclosed the plan of the premises.
- I have sent copies of this application and the plan to responsible authorities and others where applicable.
- I have enclosed the consent form completed by the individual I wish to be designated premises supervisor, if applicable.
- I understand that I must now advertise my application.
- I understand that if I do not comply with the above requirements my application will be rejected.

**IT IS AN OFFENCE, LIABLE ON SUMMARY CONVICTION TO A FINE NOT EXCEEDING LEVEL 5 ON THE STANDARD SCALE, UNDER SECTION 158 OF THE LICENSING ACT 2003, TO MAKE A FALSE STATEMENT IN OR IN CONNECTION WITH THIS APPLICATION.**

**Part 4 – Signatures** (please read guidance note 10)

**Signature of applicant or applicant’s solicitor or other duly authorised agent** (see guidance note 11). **If signing on behalf of the applicant, please state in what capacity.**

Signature	<i>Thomas &amp; Thomas</i>
Date	18/06/2015
Capacity	Thomas & Thomas Partners LLP, Solicitors on behalf of the Applicant

**For joint applications, signature of 2<sup>nd</sup> applicant or 2<sup>nd</sup> applicant’s solicitor or other authorised agent** (please read guidance note 12). **If signing on behalf of the applicant, please state in what capacity.**

Signature	
Date	
Capacity	

Contact name (where not previously given) and postal address for correspondence associated with this application (please read guidance note 13) Our ref: AT/ZIN.1.1 Ryan Peermamode Thomas & Thomas Partners LLP 38a Monmouth Street			
Post town	London	Postcode	WC2H 9EP
Telephone number (if any)	020 7042 0417		
If you would prefer us to correspond with you by e-mail, your e-mail address (optional) rpeermamode@tandtp.com			

#### Notes for Guidance

1. Describe the premises, for example the type of premises, its general situation and layout and any other information which could be relevant to the licensing objectives. Where your application includes off-supplies of alcohol and you intend to provide a place for consumption of these off-supplies, you must include a description of where the place will be and its proximity to the premises.
2. Where taking place in a building or other structure please tick as appropriate (indoors may include a tent).
3. For example the type of activity to be authorised, if not already stated, and give relevant further details, for example (but not exclusively) whether or not music will be amplified or unamplified.
4. For example (but not exclusively), where the activity will occur on additional days during the summer months.
5. For example (but not exclusively), where you wish the activity to go on longer on a particular day e.g. Christmas Eve.
6. Please give timings in 24 hour clock (e.g. 16:00) and only give details for the days of the week when you intend the premises to be used for the activity.
7. If you wish people to be able to consume alcohol on the premises, please tick 'on the premises'. If you wish people to be able to purchase alcohol to consume away from the premises, please tick 'off the premises'. If you wish people to be able to do both, please tick 'both'.
8. Please give information about anything intended to occur at the premises or ancillary to the use of the premises which may give rise to concern in respect of children, regardless of whether you intend children to have access to the premises, for example (but not exclusively) nudity or semi-nudity, films for restricted age groups or the presence of gaming machines.
9. Please list here steps you will take to promote all four licensing objectives together.
10. The application form must be signed.
11. An applicant's agent (for example solicitor) may sign the form on their behalf provided that they have actual authority to do so.
12. Where there is more than one applicant, each of the applicant or their respective agent must sign the application form.
13. This is the address which we shall use to correspond with you about this application.

**Consent of individual to being specified as premises supervisor**

Joshua James Magidson

-----  
*[full name of prospective premises supervisor]*

of

29 Summerland Gardens, London, N10 3QP

-----  
*[home address of prospective premises supervisor]*

-----  
*Date of birth: 14/03/86*

hereby confirm that I give my consent to be specified as the designated premises supervisor in relation to the application for

New Premises Licence

-----  
*[type of application]*

by

Zing Zing Express Ltd

-----  
*[name of applicant]*

relating to a premises licence

N/A

-----  
*[number of existing licence, if any]*

for

Zing Zing  
142 Blackstock Road  
London  
N4 2DX

-----  
*[name and address of premises to which the application relates]*

and any premises licence to be granted or varied in respect of this application made by

Zing Zing Express Ltd

-----  
*[name of applicant]*

concerning the supply of alcohol at

Zing Zing  
142 Blackstock Road  
London  
N4 2DX

-----  
*[name and address of premises to which application relates]*

I also confirm that I am applying for, intend to apply for or currently hold a personal licence, details of which I set out below.

Personal licence number

TBC

-----  
*[insert personal licence number, if any]*

Personal licence issuing authority

TBC

-----  
*[insert name and address and telephone number of personal licence issuing authority, if any]*

Signed

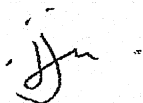

Name (please print)

JOSHUA JAMES MAGIDSON

Date

10/06/15



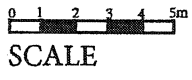
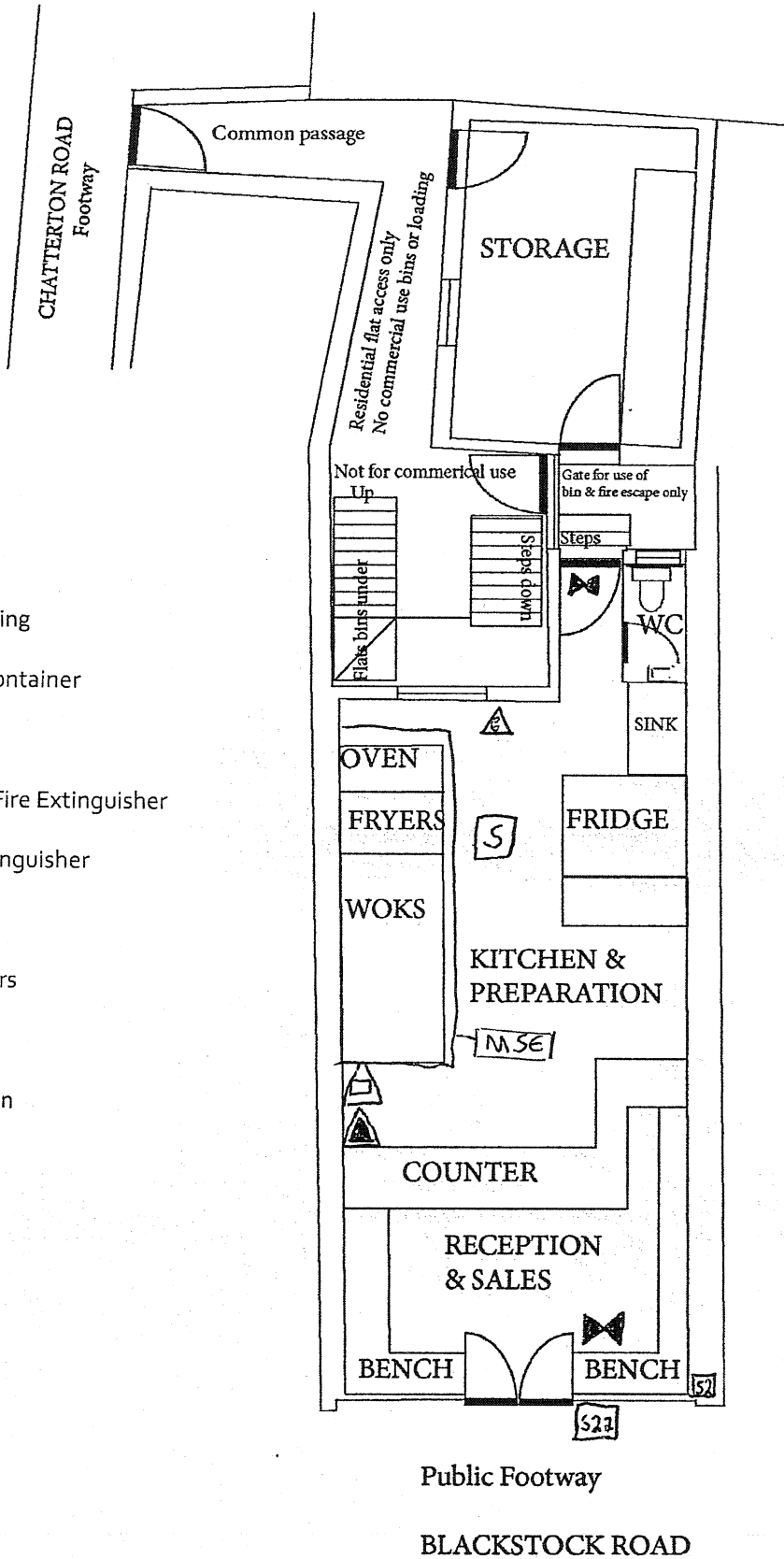

GROUND FLOOR SHOP PLAN

Project:  
142 Blackstock Road

Scale: 1:200 @ A4      Date: 28.03.15

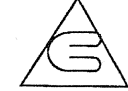

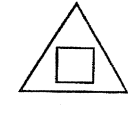
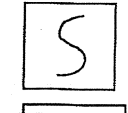
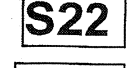
Fire Safety Legend

-  Emergency lighting
-  Fire Blanket in container
-  Carbon Dioxide Fire Extinguisher
-  Dry Powder Extinguisher
-  Smoke Detectors
-  Signage
-  Smoke Extraction



BASEMENT FLOOR PLAN

Project:  
142 Blackstock Road

Scale:            Date:  
1:200 @ A4    28.03.15

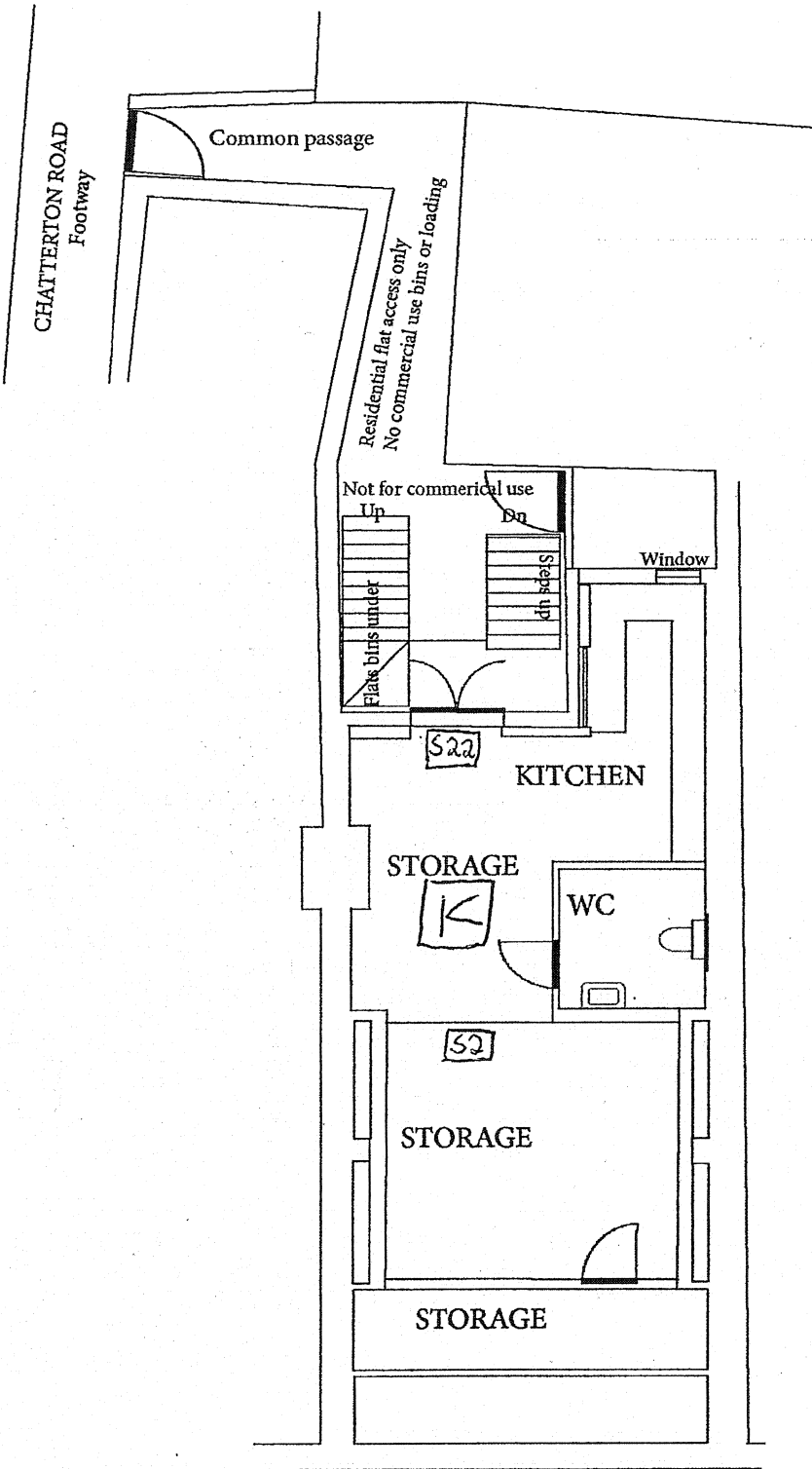
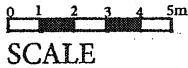

**Licensing Act 2003 representation pro-forma**

Should you wish to comment on the licence application please use this form to help you. Please feel free to attach additional sheets.

You do not have to make any comment, and comments may be made in support of as well as against the application, providing they refer to one or more of the licensing objectives (please see the guidance notes for further advice).

Premises Name and address Zing Zing 142 Blackstock Rd N4 2DX

Your Name: [REDACTED]  
Interest: Local resident  
(E.g. resident, business, TRA Chair, Councillor, solicitor)  
Your Address: 24 Chatterton Rd N4 2DX  
Email: [REDACTED]  
Telephone: [REDACTED]

Please comment on the licensing objectives below relevant to your concerns or observations, you may also wish to include suggestions how your concerns could be addressed:

*My first observation is that this letter was not delivered to every resident - I only found out about this by word of mouth from a neighbour. I am somewhat suspicious therefore that this form was delivered only to customers of Zing Zing therefore removing the possibility of any representations actually being received or logged by local residents, allowing the licence to be granted automatically.*

**Public Nuisance**

If selling alcohol on off sales basis there is no control over customers opening bottles or cans & consuming contents on highway outside premises whilst awaiting their take away.

Could lead to drunkenness & disorderly behaviour therefore causing public nuisance - especially on match days

Premises have no WC for use of patrons therefore drinking would possibly lead to urinating on the highway - there is already evidence of bad waste management with showing grease stains etc & oil spillage from the motor cycles on the pavements with no attempt by the establishment to clear them up. LBI already has a very high Council Tax rate why should I as a resident pay towards cleaning up after an irresponsible business. I live in Chatterton Rd & at the end of my lies Chatterton Mews - a quiet, small, dead end road ideally situated for such public nuisance or covert activities

The delivery motor cycles are driven on the pavement therefore presenting potential for accidents with the public

Within a 3 block distance from my home we already have 5 off sales outlets (1 of which is open 24/7), 6 restaurants & 2 pub/bars all selling alcohol - there is no need for a further

licenced outlet in this vicinity.

I have never known of a take away establishment to have a alcohol licence. Should you grant this one it will set a precedent in the area. With 5 take aways & 3 cafe's within the same 3 block area we would see an alcohol frenzy if they all follow suit and apply for the same off licence to sell alcohol

On match days we are saturated with people consuming alcohol on the highway

On 1 such football celebration I was stopped from entering a local grocers at 9pm buy a police officer, & instructed not to buy alcohol due to the drunken behaviour of the revellers - local residents do not require a further outlet to add to such behaviour.

I

#### **Crime & Disorder**

This establishment has already been targeted by immigration for illegal immigrant workers - the area was flooded with immigration officers and police officers.

Therefore they have already flouted the laws of this land. Given a licence to sell alcohol will allow them to buy/sell illegal alcohol with god knows what ingredients. This would present danger to those who consume it, break licensing laws & breach HMRC requirements on revenue

Lack of control over customers opening & consuming alcohol on highways outside the establishment could lead to drunken disorderly behaviour & result in law breaking such as vandalism, mugging, theft, fighting, damage to property/vehicles etc or even burglary

#### **Protection of Children from Harm**

Proposal for licence to sell alcohol from 12.00 to 23.00. Any such drunken anti social behaviour or public nuisance such as urinating, fighting, theft, damage etc can be witnessed by young children coming from school.

The previous visit by immigration and the police was during the day

As no separate bar area for the sole purpose of selling alcohol is evident on the premises young people (15 or 16) may be able to purchase alcohol with their take away meal therefore encouraging underage drinking

The delivery motor cycles are driven on the pavement therefore presenting potential for accidents with children

**Public Safety**

Lack of control over customers opening & consuming alcohol on highways outside the establishment could lead to drunken disorderly behaviour & result in law breaking such as vandalism, mugging, theft, fighting, damage to property/vehicles etc or even burglary

I wish my identity to be kept anonymous  Yes  No -

Copies of this representation will be sent to the applicant, or their agent/solicitor, including name and address details (but other personal contact information such as telephone numbers and email addresses will be removed) unless you have specifically requested anonymity.

Copies of this representation will be included in a report that will be available to the public and will be published on the internet; however the published on-line version of the report will have name and address details removed.

Signature \_\_\_\_\_

Date \_\_\_\_\_

**Please ensure name and address details completed above**

Return to:

Licensing Service  
London Borough of Islington  
3rd Floor  
222 Upper Street  
London N1 1XR

or send by email to:

[licensing@islingto.gov.uk](mailto:licensing@islingto.gov.uk)

**Licensing Act 2003- Representation from the Licensing Authority**  
**Application: Zing Zing, 142 Blackstock Rd, London N4 2DX**

I am submitting a representation on behalf of the Licensing Authority with respect to the new premises licence application to permit off sales of alcohol until 23:00 hours.

The grounds for the representation are:

- Public nuisance
- Protection of children from harm

The premises is not located in a cumulative impact area so there is no presumption that the application should be refused and the onus is on responsible authorities and other persons to demonstrate that granting the licence will undermine the licensing objectives.

The premises are located in an area with a significant number of licensed premises and in an area where the licensing authority has concerns about alcohol related public nuisance and under age consumption of alcohol.

**Licensing Policy Considerations**

Licensing Policy 9 Operating schedule

Licensing Policy 19 Deliveries and Collections

Licensing Policy 25 Children and Alcohol

**Issues of Concern**

We have received a number of residential complains about refuse being left on the pavement and also complaints about noise from delivery vehicles.

The licensing authority also has concerns about young people using the delivery service to obtain alcohol.

The operating schedule is not sufficiently robust to mitigate against these concerns. If the Licensing Committee grants the licence, it should be subject to additional conditions detailed below.

**Recommendations**

In order to promote the licensing objectives it is recommended that the following conditions are attached to the licence.

- Couriers responsible for deliveries shall be at least 21 years old.
- Couriers shall be trained on relevant aspects of the Licensing Act 2003 including underage sales, sales to a person who is drunk, obtaining alcohol for a child or a person who is drunk and delivering alcohol to someone under the age of 18.
- Any person taking an order for the supply of alcohol on behalf of the premises licence holder will inform all customers that proof of age by way of photographic driving licence, passport or a form of identification with the PASS hologram will be required before alcohol is supplied.
- Promotional material shall clearly display that it is illegal for customers under the age of 18 to make a purchase of alcohol
- On delivery, each customer will be required to sign a declaration confirming that they are over 18 before alcohol is supplied
- There shall be a written record kept of all refusals which shall be made available to

- the Licensing Authority or the Metropolitan Police on request
- The Premises Licence Holder shall ensure that measures are in place to remove litter or waste arising from their customers and to prevent such litter from accumulating in the immediate vicinity of their premises.
  - The premises cooking extraction system will be switched off when not required for cooking purposes.
  - Odour from the cooking extraction system flue shall not cause nuisance to the occupants of any properties in the vicinity.
  - All delivery bikes will receive and return deliveries to the premises rear entrance in Citizen Road.
  - The delivery of goods shall be restricted to between the hours of 07:00 and 23:00 Mondays to Fridays 07:00 - 13:00 Saturdays, and not take place on Sundays and Bank Holidays.
  - All rubbish produced by the premises shall be stored securely in a sufficient number of bins with tight fitting lids or otherwise suitably contained.
  - Arrangements will be put in place to ensure that waste collection contractors do not collect refuse between 1900 and 0700 Mondays to Sundays.
  - Suitable signage shall be positioned at the premises exits requesting customers to make as little noise as possible and avoid disturbing neighbours when leaving the premises.

Janice Gibbons  
Service Manager  
[Janice.gibbons@islington.gov.uk](mailto:Janice.gibbons@islington.gov.uk)  
020 7527 3212

15 July 2015

REP 3

Your New License Application  
Our Licensing/NI  
Date: 15/07/2014



METROPOLITAN POLICE  
SERVICE  
Islington Police Licensing Team  
Islington Police Station  
2 Tolpuddle Street  
London  
N1 0YY

Telephone: 07799133204  
Email:  
Licensingpolice@islington.gov.uk

Date 15th July 2014

Zing Zing  
142 Blackstock Road  
London  
N4 2DX

Dear Sir

**Re: New Premises License application: 142 Blackstock Road London N4 2DX**

With reference to the above application, We are writing to inform you that the Metropolitan Police, as a Responsible Authority, will be objecting to this application as it is our belief that if granted the application would undermine the Licensing Objectives, Crime and disorder and protecting children from harm.

The area, although not a Cumulative Impact Area, still has a number of nearby Licensed premises.

We have concerns on how takeaway alcohol will be regulated, the applicant has stated that the sale of alcohol will be ancillary to the purchase of food so does this mean that one item can be purchased from the menu and then an unlimited number of alcoholic drinks can then be purchased?

How will the age of persons ordering a delivery by phone or internet be established? And how will the amount of alcohol supplied with the meal be regulated?

What will be the age of the persons delivering the takeaway meals and how will they be trained in alcohol awareness?

We received the application on 18th June 2015 and we emailed the applicants agent on 20th June asking questions about the above, as yet we have not had a reply. This lack of engagement does not bode well and does not give us confidence in the applicant's ability to run the venue to the standard we would expect.

It is for these reasons that we are objecting to the application.

We would ask that if the Committee is of a mind to grant this application that they consider adding the following conditions to the License:

1. CCTV shall be installed, operated and maintained in agreement with the Police. Maintained means that the system will be regularly serviced (at least once a year) and checked every two weeks to ensure that it is storing images correctly and a log kept and signed by a Supervisor to this effect. The system will provide an identifiable full head and shoulder image of everyone entering the premises and will operate in any light conditions within the premises. The system will cover the full exterior of the premises and shall record in real time, date and time stamped and will operate whilst the premises is open for licensable activities. The recordings will be kept for a minimum of 31 days and copies will be made available to an Authorised Officer or a Police Officer (subject to the Data Protection Act 1998) within 24hrs of any request free of charge. There will always be a member of staff on duty who can operate the system, to allow Officers to view recordings and if required by a Police Officer, provide a copy of images immediately free of charge to assist in the

immediate investigation of offences. If the system malfunctions and will not be operating for longer than one day of business then Police licensing officers must be informed

2. The premises should adopt the Challenge 25 proof of ID scheme.

3. Persons delivering take away meals to be a minimum age of 21

4. All staff to be trained on the relevant aspects of the Licensing Act 2003, underage sales, sales to a person who is drunk, obtaining alcohol for a child or a person who is drunk and delivering alcohol to someone under the age of 18.

5. Staff to inform customers at the time of ordering alcohol that proof of age is required such as, Passport, photo driving license or a form of ID with the PASS hologram before alcohol is supplied.

Should you wish to discuss the matter further please contact us on Mobile 07799133204 or via email, [Licensingpolice@islington.gov.uk](mailto:Licensingpolice@islington.gov.uk)

Yours sincerely

Islington Police Licensing Team  
Pc Steven Harrington  
Pc Peter Conisbee  
Pc Nick Pamboris



REPS

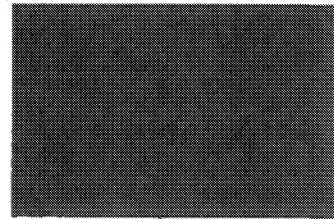

14<sup>th</sup> July 2015

Dear John Williams,

**Re: Licensing Act 2003 – Premises license application new**  
**Address: Zing Zing, 142 Blackstock Road, N4 2DX**

**Public nuisance**

There are over 15 licensed premises that I know of within approximately 80 meters of this premises. There is already a huge concentration of licensed premises and none of them are takeaways so this would set a bad precedent. This would only cause more anti social behaviour with people drinking on the street while waiting for their takeaway thus increasing litter. Zing Zing will end up dumping even larger amounts of waste and obstructing the pavement too. The pavements are really filthy and you can see large amounts of oil slick stains on the pavement even along Chatterton Road. As an OAP I find it difficult to walk past their premises with their bikes, waste, slippery oil marks and large advertising board obstructing the pavement.

**Crime & disorder**

Public nuisance will increase especially public urination on my road on match days. The general increase in intoxicated behaviour would be detrimental to the living standard of local residents. There would also be the question of whether the alcohol is being sourced and supplied legally as there has been many incidents in the local area of this not actually happening.

**Protection of children from harm**

The above premises were raided by immigration officers which would be a great concern to protection of children from harm. This could also lead to the possibility of children being served alcohol and being exposed to drunken, anti social laddish behaviour.

**Public safety**

Their drivers constantly ride on the pavement and I have told Mark the owner on more than 1 occasion as well as the manager but they have done nothing. Instead on each occasion they defend their drivers and refuted that this ever happened. The illegal riding on pavements still continues despite telling the drivers directly not to do this too.

Yours sincerely,

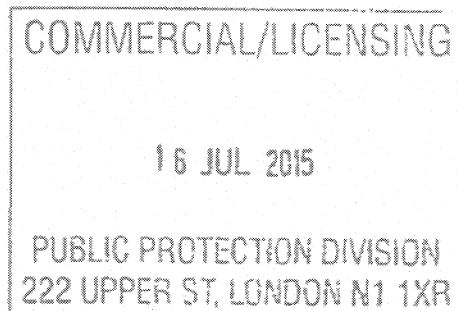

**Williams, John**

---

**From:** [REDACTED]  
**Sent:** 14 July 2015 15:50  
**To:** Licensing  
**Subject:** Representation - Zing Zing, 142 Blackstock Road, N4 2DX

Dear Mr John Williams,

**Licensing Act 2003, New premises license application**

**Address: Zing Zing, 142 Blackstock Road, N4 2DX.**

#### **Public nuisance**

- Area is saturated with license premises
- Increase in antisocial behaviour
- Increase in street drinking
- Increase street litter
- Increase the burden on the police
- Increase the burden on the NHS on weekends

#### **Crime & disorder**

- Increase in public urination.
- Increase in shouting.
- Increase in swearing.
- Increase antisocial behaviour.
- My friend works in A&E and on the weekend it is filled with people that have had too much to drink and are very violent at times.
- The employment of illegal immigrants.

#### **Protection of children from harm**

- Children of all ages will be exposed to alcohol during and after licensing hours.
- Children will also be exposed to the aftereffects of alcohol.
- Children may be able to buy alcohol in store or online for home delivery.

#### **Public safety**

- Increase in drunkenness and antisocial behaviour.

### Appendix 3

1. The sale of alcohol shall be ancillary to the purchase of food.
2. Alcohol shall not be sold in open containers or be consumed in the licensed premises.
3. CCTV shall be installed, operated and maintained in agreement with the Police. The system will enable frontal identification of every entering the premises. The system shall record in real time and operate whilst the premises are open for licensable activities. The recordings shall be kept available for a minimum of 31 days. Recordings shall be made available to an authorised officer or a Police officer (Subject to the Data Protection Act 1998) within 24 hours of any request.
4. The licensee shall put arrangement in place to ensure that before serving alcohol to young persons, staff shall ask to see accredited proof of age cards e.g. Citizencard, a Passport, or UK Driving Licence bearing the photograph and date of birth of the bearer.
5. The licensee and staff should note any refusals to sell to young persons in a refusals log. The refusals log shall be checked and signed monthly by the designated premises supervisor. The refusals log shall be made available for inspection by the licensing team, Police or trading standards officer.

### **Suggested conditions as recommended in representation from Police**

6. CCTV shall be installed, operated and maintained in agreement with the Police. Maintained means that the system will be regularly serviced (at least once a year) and checked every two weeks to ensure that it is storing images correctly and a log kept and signed by a Supervisor to this effect. The system will provide an identifiable full head and shoulder image of everyone entering the premises and will operate in any light conditions within the premises. The system will cover the full exterior of the premises and shall record in real time, date and time stamped and will operate whilst the premises is open for licensable activities. The recordings will be kept for a minimum of 31 days and copies will be made available to an Authorised Officer or a Police Officer (subject to the Data Protection Act 1998) within 24hrs of any request free of charge. There will always be a member of staff on duty who can operate the system, to allow Officers to view recordings and if required by a Police Officer, provide a copy of images immediately free of charge to assist in the immediate investigation of offences. If the system malfunctions and will not be operating for longer than one day of business then Police licensing officers must be informed (**This would replace condition 3 in agreed**)
7. The premises should adopt the Challenge 25 proof of ID scheme.
8. Persons delivering take away meals to be a minimum age of 21
9. All staff to be trained on the relevant aspects of the Licensing Act 2003, underage sales, sales to a person who is drunk, obtaining alcohol for a child or a person who is drunk and delivering alcohol to someone under the age of 18.
10. Staff to inform customers at the time of ordering alcohol that proof of age is required such as, Passport, photo driving license or a form of ID with the PASS hologram before alcohol is supplied.

### **Suggested conditions as recommended in representation from Licensing Authority.**

11. Couriers responsible for deliveries shall be at least 21 years old.
12. Couriers shall be trained on relevant aspects of the Licensing Act 2003 including underage sales, sales to a person who is drunk, obtaining alcohol for a child or a person who is drunk and delivering alcohol to someone under the age of 18.

13. Any person taking an order for the supply of alcohol on behalf of the premises licence holder will inform all customers that proof of age by way of photographic driving licence, passport or a form of identification with the PASS hologram will be required before alcohol is supplied.
14. Promotional material shall clearly display that it is illegal for customers under the age of 18 to make a purchase of alcohol
15. On delivery, each customer will be required to sign a declaration confirming that they are over 18 before alcohol is supplied
16. There shall be a written record kept of all refusals which shall be made available to the Licensing Authority or the Metropolitan Police on request
17. The Premises Licence Holder shall ensure that measures are in place to remove litter or waste arising from their customers and to prevent such litter from accumulating in the immediate vicinity of their premises.
18. The premises cooking extraction system will be switched off when not required for cooking purposes.
19. Odour from the cooking extraction system flue shall not cause nuisance to the occupants of any properties in the vicinity.
20. All delivery bikes will receive and return deliveries to the premises rear entrance in Citizen Road.
21. The delivery of goods shall be restricted to between the hours of 07:00 and 23:00 Mondays to Fridays 07:00 - 13:00 Saturdays, and not take place on Sundays and Bank Holidays.
22. All rubbish produced by the premises shall be stored securely in a sufficient number of bins with tight fitting lids or otherwise suitably contained.
23. Arrangements will be put in place to ensure that waste collection contractors do not collect refuse between 1900 and 0700 Mondays to Sundays.
24. Suitable signage shall be positioned at the premises exits requesting customers to make as little noise as possible and avoid disturbing neighbours when leaving the premises.

**Title : 88 Highbury Park**

Islington Borough  
Boundary

**Printed by :**  
RO RO

**Printed at :**  
13-08-2015

